

# FRONT LOADS

2 YARD FRONT LOAD  
WITH CASTERS &  
OPTIONAL LOCK BAR



## STANDARD CONSTRUCTION FEATURES

- Materials:
  - True-to-gauge prime 12-gauge body and 10-gauge floor panels
  - Fully welded body panels and 10-gauge bumpers
  - Lift pockets:
    - 1-4 yd: 10-gauge, 8" H x 24" L
    - 6-10 yd: 7-gauge, 8" H x 30" L
  - Fully welded leads, gussets, dirt shedders, and fork deflectors at the back
  - 10-gauge, 2" H x 4" W structural bottom channel (runs side-to-side)
  - Suspended floor prevents crushing and adds longevity, especially on asphalt surfaces
- Drainage: One 3/4" dia. threaded drain with plug per container
- Pickup Points: Equipped for booming containers on-site
- Lid Features:
  - Single-wall, vacuum-formed HDPE plastic lids by Impact Plastics
  - 1/2" dia. zinc-plated steel lid rods with Nylock nut on one end
- Casters: 6" dia. polyolefin casters with greaseable roller bearings on 1-3 yd containers (2 swivel, 2 rigid)
- Finish: Industrial enamel primer and paint provided by HIS Paint Co.
- Additional Features:
  - Steel serial number tag welded on all containers
  - Delivered fully assembled, including caution/warning decals, D.O.T. reflective tape, and customer-supplied decals

CAPACITY	LIDS (WxL)	WEIGHT (APPROX.)
1 Cubic Yard w/Casters	2 - 36" x 33"	395 lbs
1½ Cubic Yard w/Casters	2 - 36" x 33"	420 lbs
2 Cubic Yard w/Casters	2 - 36" x 41"	480 lbs
3 Cubic Yard w/Casters	2 - 36" x 47"	520 lbs
4 Cubic Yard	2 - 36" x 47" (2 - 36" x 57" on Stackable)	680 lbs
6 Cubic Yard	2 - 36" x 57"	860 lbs
8 Cubic Yard	2 - 36" x 57"	1,020 lbs
10 Cubic Yard	2 - 36" x 57"	1,170 lbs



# PLASTIC FRONT LOAD

## LIGHT WEIGHT PLASTIC AND STEEL WHERE YOU NEED IT

### STANDARD CONSTRUCTION FEATURES

- Tub: Replaceable single-wall HDPE plastic tub in black
- Frame: 14 gauge steel with 10 gauge, 8”H x 24”L pockets
- Lids: Single-wall, vacuum-formed HDPE plastic lids by Impact Plastics
- Lid Rods: ½” dia. zinc-plated steel lid rods with a nylock nut
- Casters: 6” dia. Polyolefin QR casters (2 swivel & 2 rigid) with greaseable roller bearings, fully assembled
- Finish: Industrial enamel primer and paint on the frame, with multiple color options available
- Decals: Containers come decaled and ready for use, including Caution/Warning decals, D.O.T. Reflective Tape, and any customer-supplied decals (Lids are removed for shipping, except for the top container)
- Forklift Requirement: Requires a forklift to load and unload when stacked 5 high



2 YARD PLASTIC  
FRONT LOAD

CAPACITY	LIDS	WEIGHT (APPROX.)	DIMENSIONS (H X W X D)
2 Cubic Yard	2 - 38” W x 41” L	367 lbs	53” H x 81½” W x 45” D



# FRONT LOAD DIMENSIONS

## STACKABLE

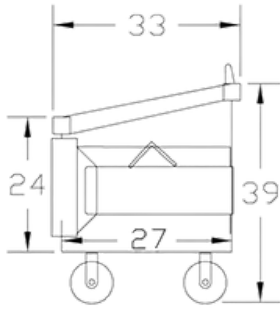

1 Yard

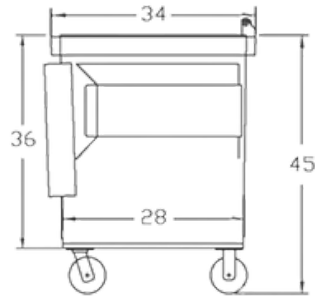

1.5 Yard

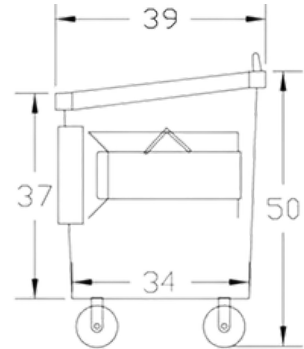

2 Yard

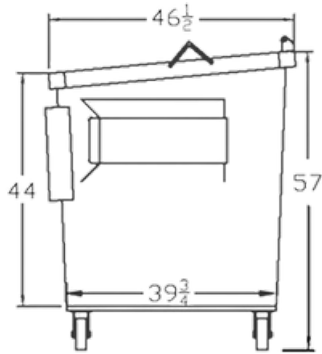

3 Yard

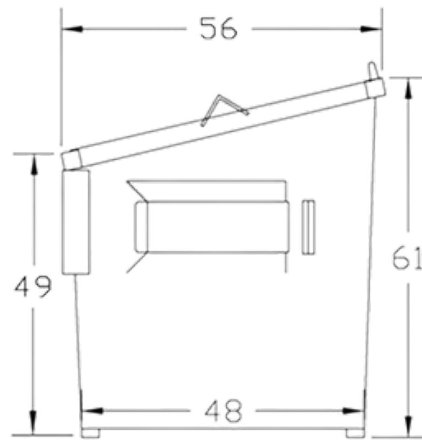

4 Yard

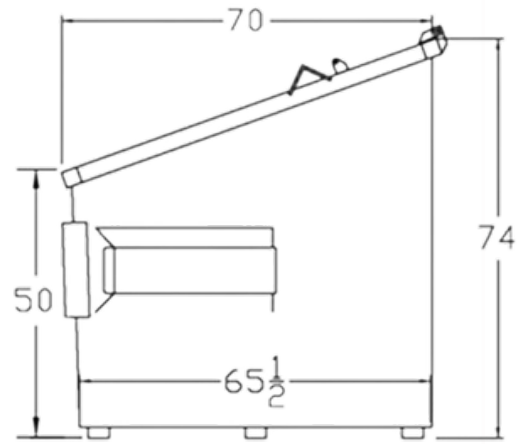

6 Yard



6 YARD FRONT LOAD  
STACKABLE

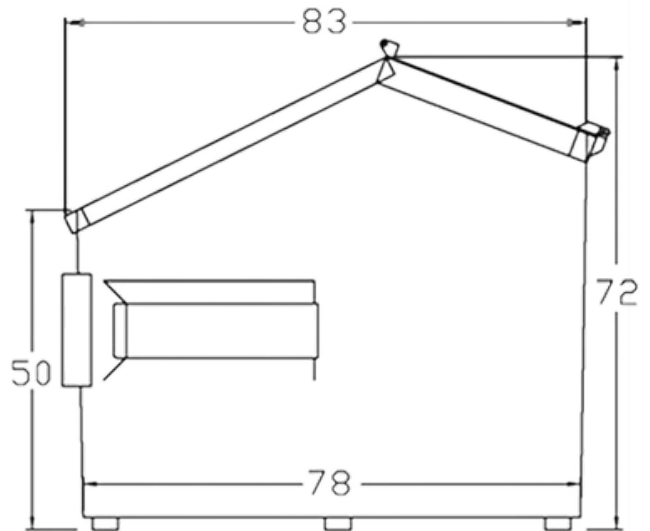

8 Yard

Outside container width: including pockets: 84"  
Casters increase container height by 8 3/4"



209 E. North Street, Poynette, WI, 53955  
Phone: 608-635-7228  
info@poynetteironworks.com

# FRONT LOAD DIMENSIONS

NON-STACKABLE

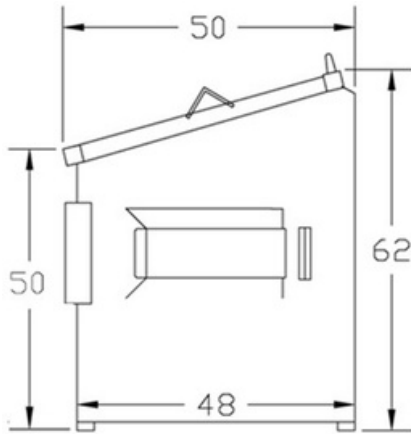

4 Yard

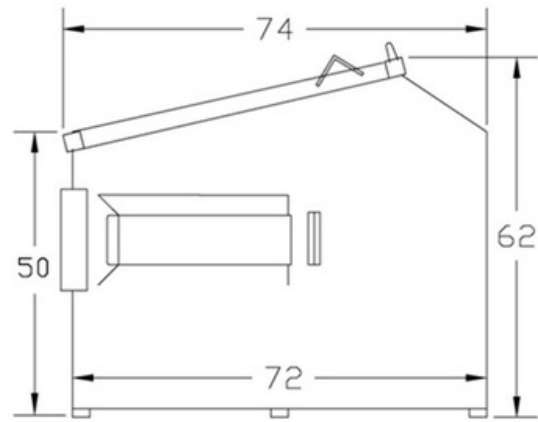

6 Yard

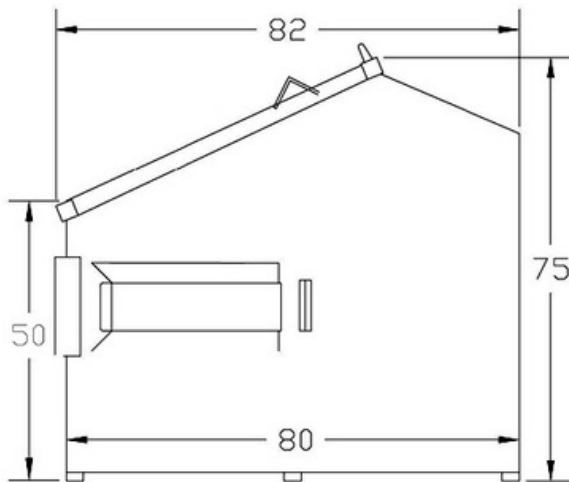

8 Yard

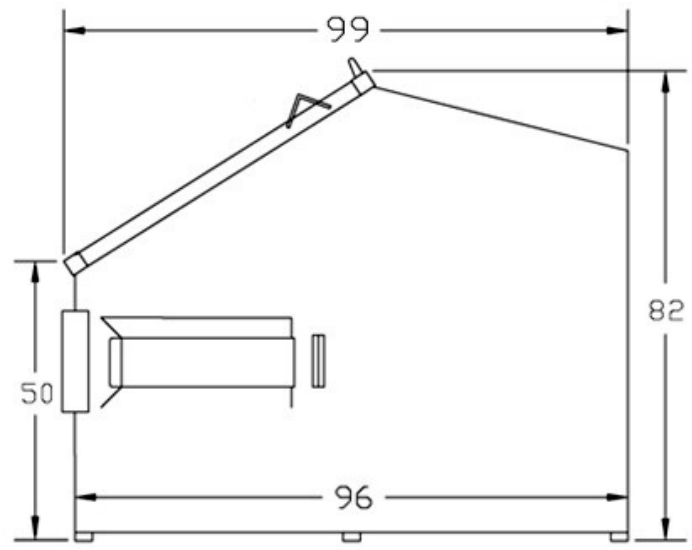

10 Yard



8 YARD FRONT LOAD  
NON-STACKABLE

Outside container width: including pockets: 84"



209 E. North Street, Poynette, WI, 53955  
Phone: 608-635-7228  
info@poynetteironworks.com

# FRONT LOADS

## LOW PROFILE & FLAT TOP STYLE

8 YARD FRONT LOAD  
LOW PROFILE



- Material: True-to-gauge prime 12-gauge body and floor panels
  - Welding: All body panels are fully welded, with fully welded 10-gauge bumpers
  - Lift Pockets:
    - 1-4 Yard: 10-gauge, 8" H x 24" L
    - 6-10 Yard: 7-gauge, 8" H x 30" L
    - Fully welded, including leads, gussets, dirt shedders, and fork deflectors at the back
  - Structural Bottom Channel: 10-gauge, 2" H x 4" W channel runs side-to-side; prevents damage on asphalt surfaces and prevents crushing. Floor is suspended off the ground, extending the container's service life
- Drainage: One 3/4" dia. threaded drain with plug per container
- Pickup Points: All containers come with pickup points for booming on site
- Lid Rods: 1/2" dia. zinc-plated steel lid rods with Nylock nut on one end
- Lids: Single-wall, vacuum-formed HDPE plastic lids by Impact Plastics
- Identification: Steel serial number tag welded on all containers
- Finish: Industrial enamel primer and paint
- Delivery: Containers are delivered fully assembled, including:
  - Caution/Warning decals
  - D.O.T. reflective tape
  - Customer-supplied decals



4 YARD FRONT LOAD  
FLAT TOP 2-LID

## FLAT TOP CONTAINERS

### LOW PROFILE CONTAINERS

CAPACITY	LIDS (WXL)	WEIGHT (APPROX.)
4 Cubic Yard	2 - 36" x 47"	660 lbs
4 Cubic Yard	4 - 36" x 41"	700 lbs
6 Cubic Yard	Front: 2 - 36" x 57" Back: 2 - 36" x 41"	890 lbs
8 Cubic Yard	Front: 2 - 36" x 57" Back: 2 - 36" x 41"	1,040 lbs
10 Cubic Yard	Front: 2 - 36" x 57" Back: 2 - 36" x 41"	1,290 lbs

CAPACITY	LIDS (WXL)	WEIGHT (APPROX.)
3 Cubic Yard	2 - 36" x 47"	340 lbs
4 Cubic Yard	2 - 36" x 57"	640 lbs
6 Cubic Yard	2 - 36" x 57"	860 lbs
8 Cubic Yard (54" H)	4 - 36" x 41"	1,020 lbs
8 Cubic Yard (72" H)	2 - 36" x 57" 4 - 36" x 41"	1,030 lbs
10 Cubic Yard	2 - 36" x 57" 4 - 36" x 41"	1,170 lbs



# FRONT LOAD DIMENSIONS

## LOW PROFILE

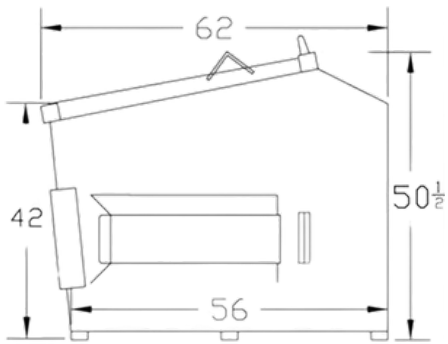

4 Yard | 2-Lid

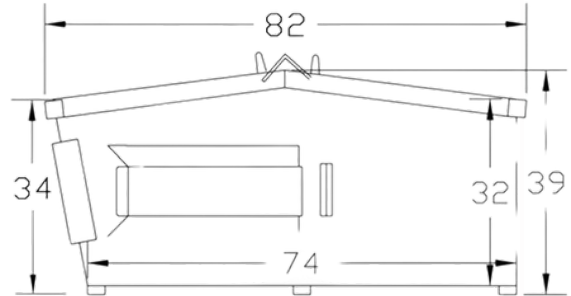

4 Yard | 4-Lid

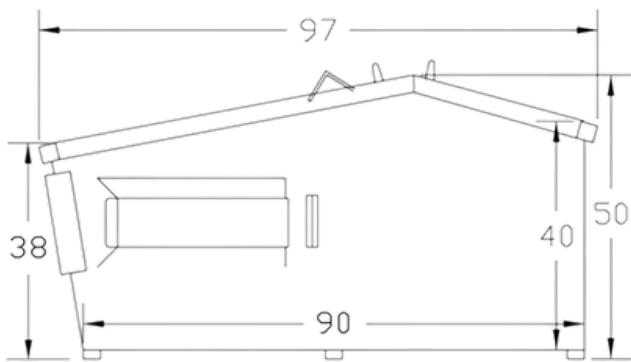

6 Yard

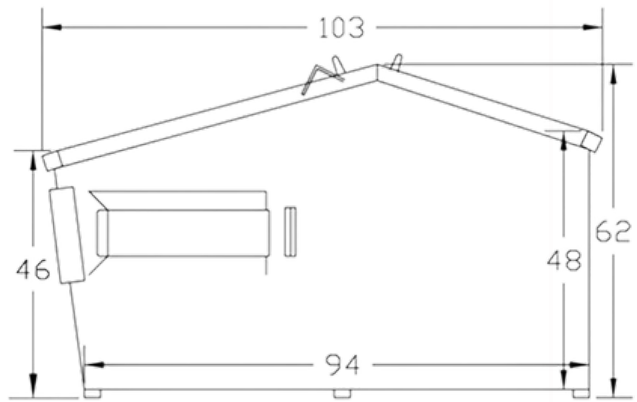

8 Yard

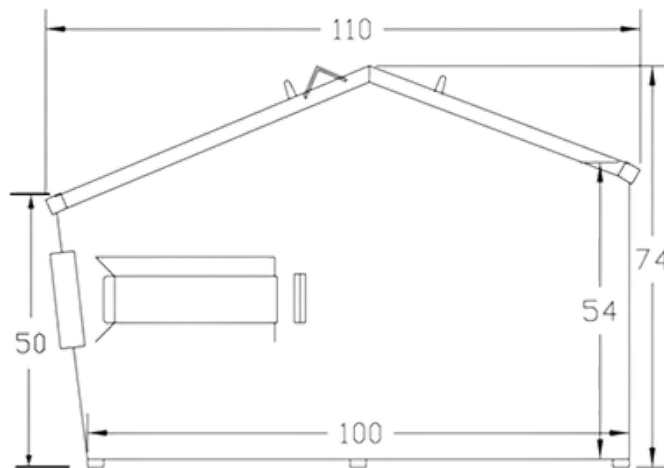

10 Yard

Outside container width: including pockets: 84"



209 E. North Street, Poynette, WI, 53955

Phone: 608-635-7228

info@poynetteironworks.com

# FRONT LOAD DIMENSIONS

## FLAT TOP

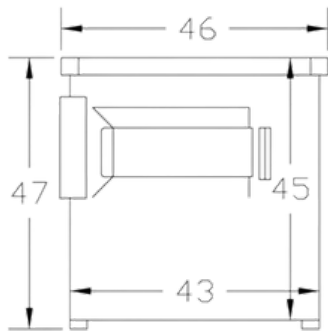

3 Yard

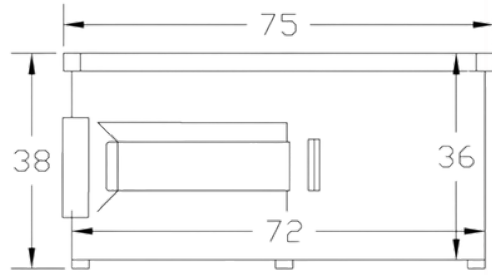

4 Yard

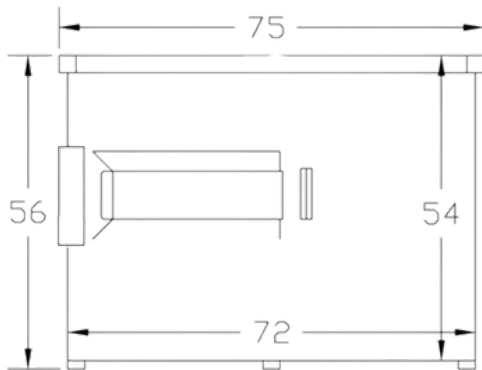

6 Yard

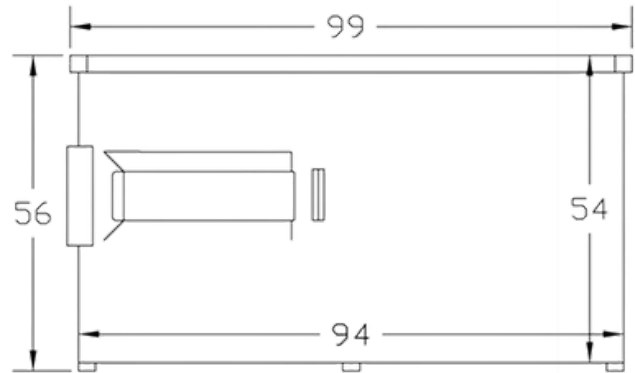

8 Yard | 54" Height  
Tapered for Stacking

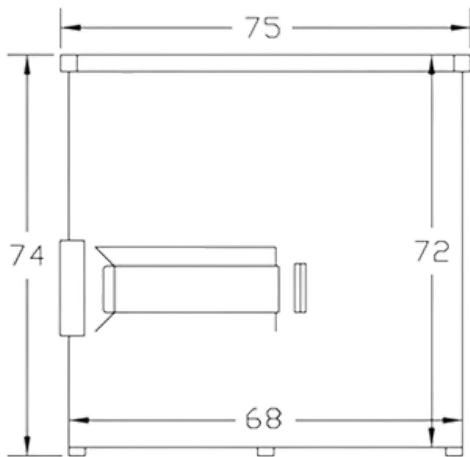

8 Yard | 72" Height  
Tapered for Stacking

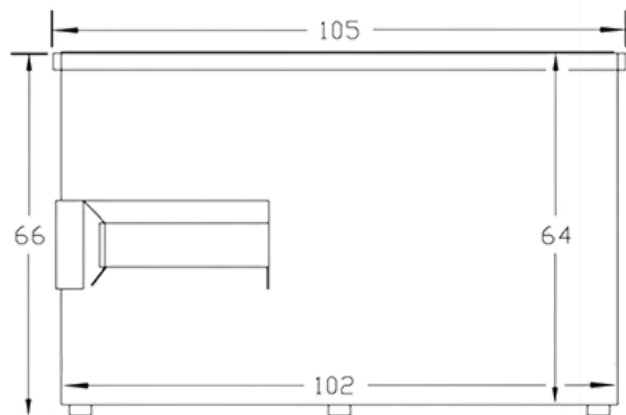

10 Yard

Outside container width: including pockets: 84"

# FRONT LOADS

## BARN/DOCK STYLE

8 YARD FRONT LOAD  
BARN/DOCK STYLE



### STANDARD CONSTRUCTION FEATURES

- Materials:
  - True-to-gauge prime 12-gauge body and floor panels
  - Fully welded body panels and 10-gauge bumpers
  - Lift Pockets: 7-gauge, 8" H x 30" L, fully welded (includes leads, gussets, dirt shedders, and fork deflectors at the back)
  - Structural Bottom Channel: 10-gauge, 2" H x 4" W structural bottom channel runs side to side; prevents damage on asphalt surfaces and prevents crushing. Floor is suspended off the ground, adding years of service
- Drainage: One 3/4" dia. threaded drain with plug per container
- Pickup Points: Containers come with pickup points for booming on-site
- Lid Rods: 1/2" dia. zinc-plated steel lid rods with Nylock nut on one end
- Lids: Single-wall, vacuum-formed HDPE plastic lids supplied by Impact Plastics
- Identification: Steel serial number tag welded on all containers
- Finish: Industrial enamel primer and paint
- Delivery: Containers are delivered fully assembled, including:
  - Caution/Warning decals
  - D.O.T. reflective tape
  - Customer-supplied decals



8 YARD FRONT LOAD  
BARN/DOCK STYLE

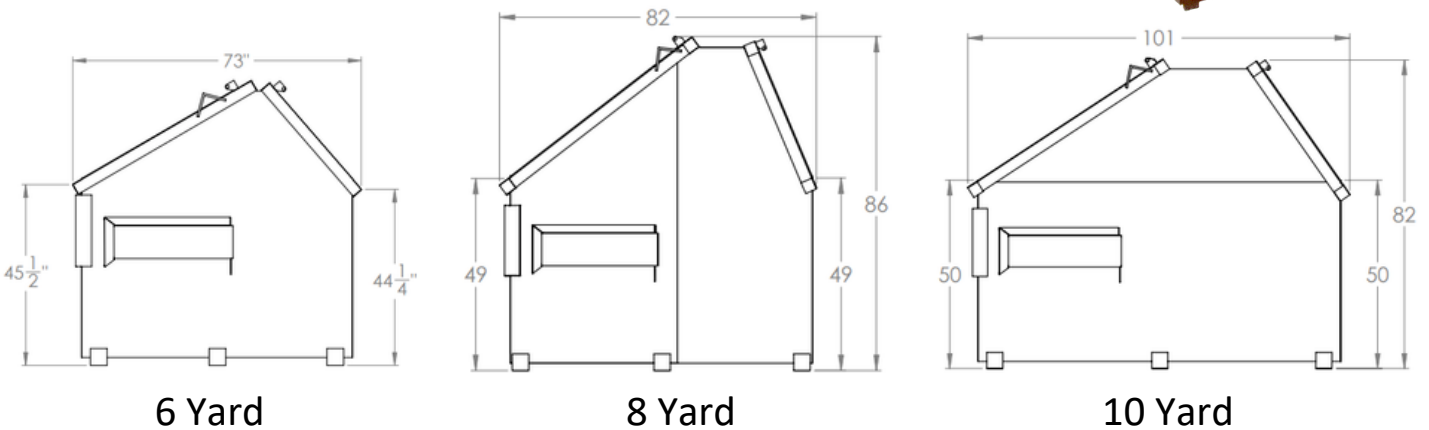

Outside container width: including pockets: 84"

CAPACITY	LIDS (WXL)	WEIGHT (APPROX.)
6 Cubic Yard	Front: 2 - 36" x 48"   Back: 2 - 36" x 33"	1,182 lbs
8 Cubic Yard	Front: 2 - 36" x 57"   Back: 2 - 36" x 41"	1,020 lbs
10 Cubic Yard	Front: 2 - 36" x 57"   Back: 2 - 36" x 41"	1,170 lbs



# SERIO-US LOCKS

## AUTOMATIC CONTAINER LOCKING SYSTEM

**Just Pull Up ...**



**... Lift ...**

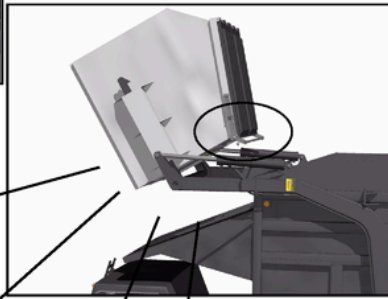
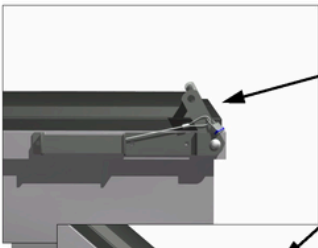

**... And Go!**



Your *Serio-us*® Lock  
unlocks automatically as the  
can is dumped ...

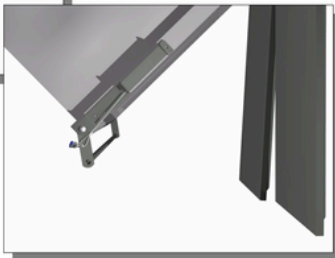
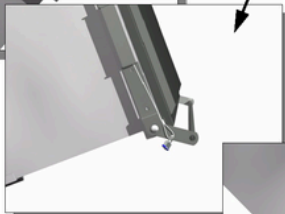
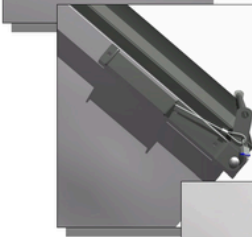

... and *relocks* automatically,  
after the lids close, as the can is  
set back down.

**Your Driver  
Never Leaves the  
Truck!**

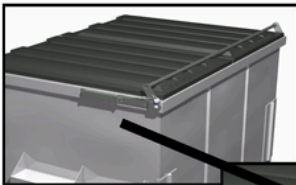

Your customer  
opens the can by  
unlocking and re-  
moving a padlock

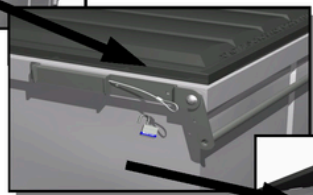

**SERIO-US LOCK**  
TESTED QUALITY • TRUSTED SERVICE

© 2009, Serio-us Industries, Inc. 1010 081007

U.S Patent No. 5,662,364